

Why is Fairfield so different?

FAIRFIELD LIBRARY
26 OCTOBER 2024

Fairfield on Homely.com.au (1)

Great for

- Clean & green
- Parks and recreation
- Public transport
- Parking
- Internet access

Fairfield on Homely.com.au (2)

Not great for

- Nightlife
- Eating out

Fairfield on Homely.com.au (3)

Who lives here?

- Professionals
- Families With Kids
- Retirees
- Singles
- Students

Ranked 140th best suburb by locals in Brisbane Region

Juz at Homely.com.au

Fairfield is fabulous. My husband and I have lived here for nearly 20 years. There's lots of beautiful parks and greenery, a great little local shopping centre that houses Coles and other shops and a strong community spirit.

With a range of housing options, Fairfield has been a great place to live. When we were in our 20's - close to the city to go out. Great in our 30's when we were renovating and starting a family (lots of parks for those walks with the pram) and now we're in our 40's and our kids are in school there are some great options.

State schools, private primary schools and proximity to high schools. University is just over the green bridge and we're close to the PA & Mater Hospital.

Fairfield on Wikipedia (cons)

- There are no schools in Fairfield.
- No major businesses are based in Fairfield
- There are only two churches
- There is no strip shopping
- There are no entertainment establishments.



**THERE IS
LITERALLY
NOTHING
HERE**

Fairfield on Wikipedia (pros)

- Fairfield has a Skate Park that caters for young people in the suburb.
- It has many other parks.

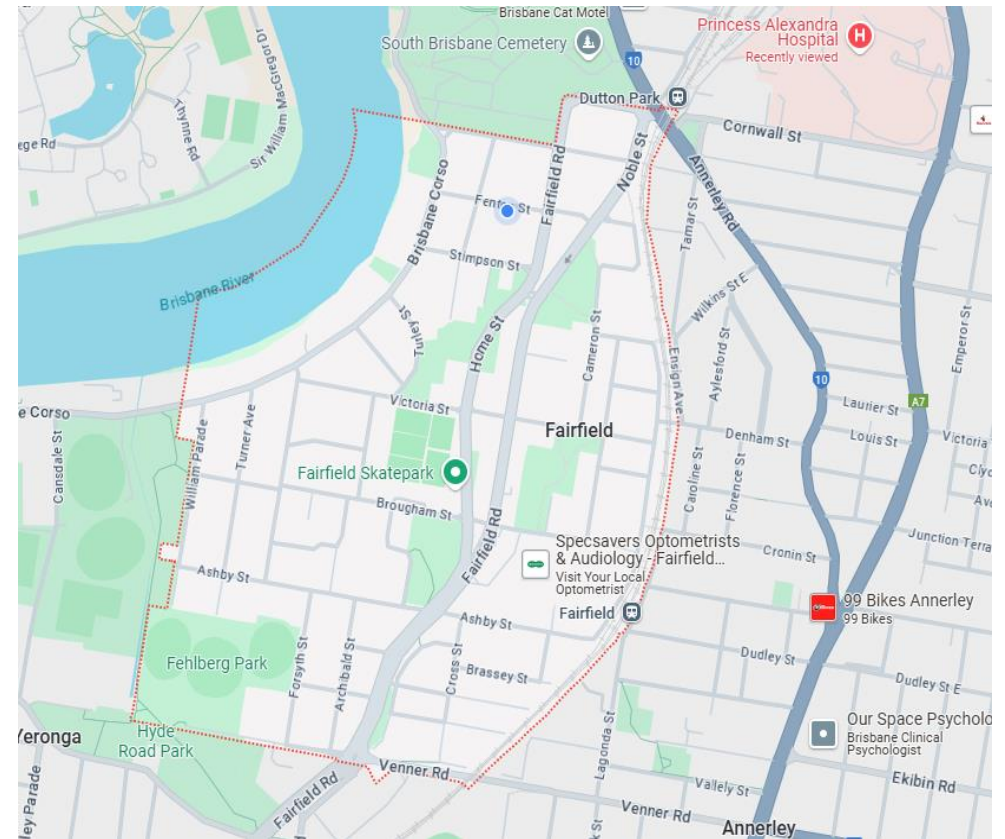

Geography

The small suburb of Fairfield (about 1.2 square kilometres) is 5 km south of central Brisbane.

It is quite flat except for hills at Castle Street and Wilkins Street, and at its northern boundary with Dutton Park and on the border with Annerley.

The area has been frequently flooded over thousands of years. The fertile land contained lagoons interspersed with groves of tall timbers.

Fairfield is part of the flood plain of Maiwar (Brisbane River).

1933 Bureau of Industry map of Maiwar flood plain



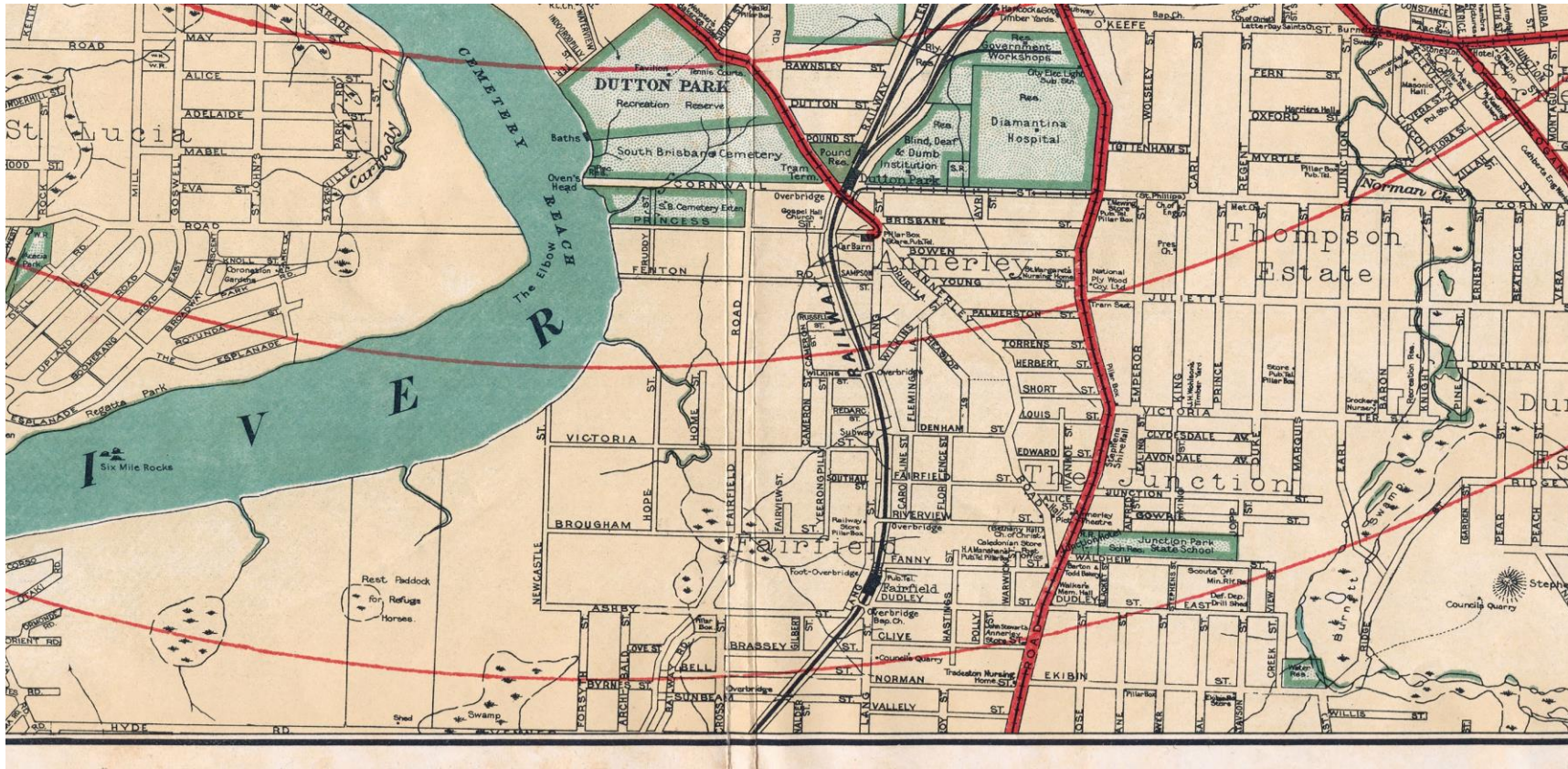

1924 Historical Souvenir Map

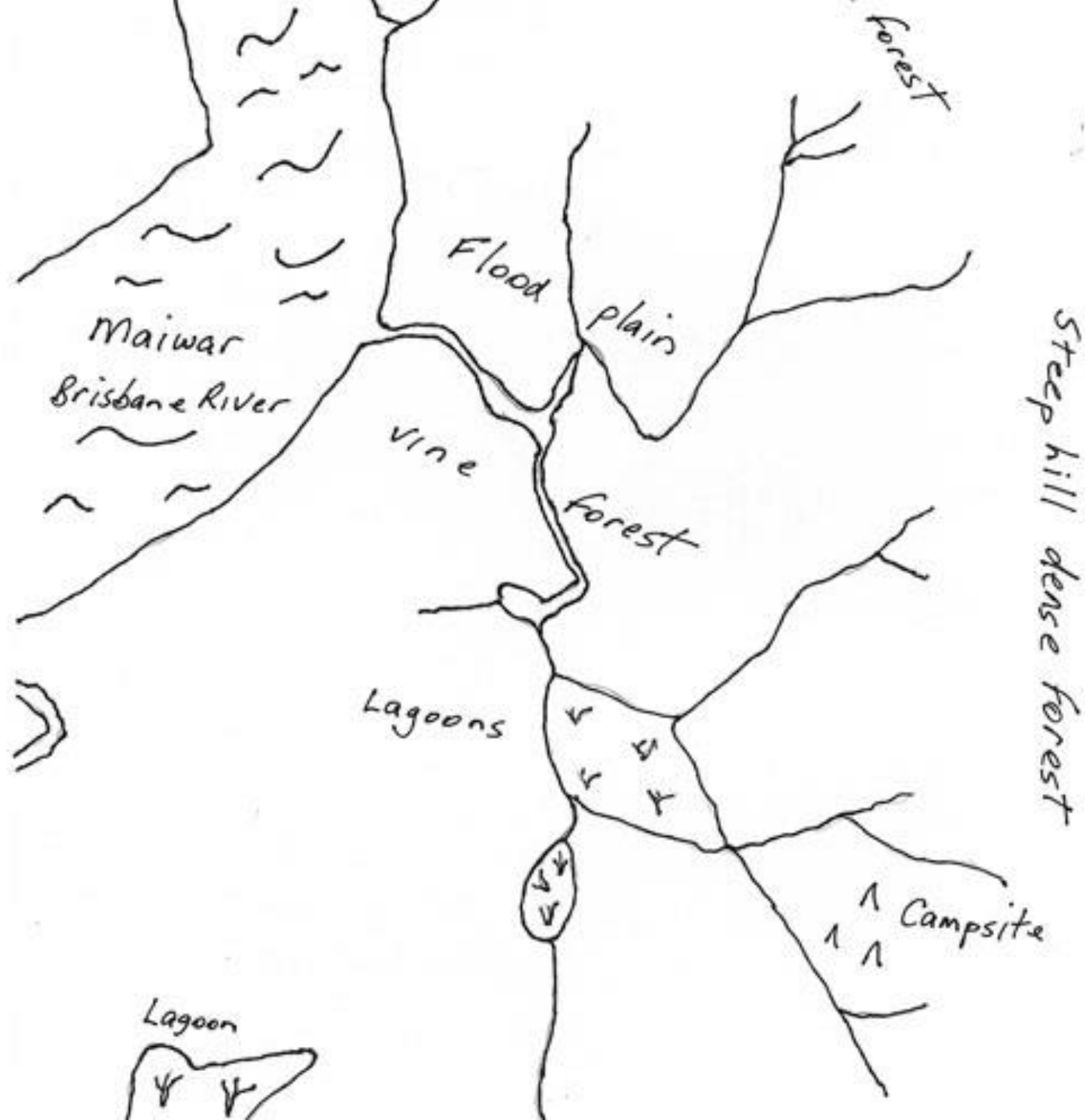

Fairfield
c. 6,000 to 200
years ago



Convict
settlement
period
1824 - 1842



The Boggo Scrub

ICE.

**E FAIRCLOTH and
ALD, Junr.,** under the
RAY & CO., will hence-
discharge all liabilities,
of the late Mr. Gray's

his sixth day of October,

ANNAH GRAY,
Administratrix.

White Flour.

**AGENTS for Messrs.
CO.'S brand,** known to
Flour in the Colonies,
to execute orders.
GEORGE RAFF & CO.,
Brisbane.

Plantain.

distance within five miles
at 37s. per hundred.
Arrowroot Bulb, purple
planting.
G. & S. GRIMES.
15th, 1862.

NOTICE! A large
store to be sold cheap;
wholesale and retail, at
Dr. Fullerton's.

Stores of the Under-

Succession brands:—

11s
11s, in 100 lb. bags
in 100 lb. and 200 lb. bags
, and Chaff
f-chests
Crystals, Counters and
any's Pieces

Wickham-street.

Land Orders taken at current rates.
Transfer under the New Act, which will only
cost a few shillings.
Terms liberal.

SATURDAY, NOVEMBER 15.
FAIRFIELD TOWNSHIP.
FOR POSITIVE SALE.

TRENDLE & CAMERON have received in-
structions to sell, on **SATURDAY,** No-
vember 15th inst., at their Rooms, Queen-street,
at 12 o'clock,

The whole of the remaining portion of the
above Township, well known to the
public generally as the Coal Company's
Scrub Land, on the bank of the river,
adjoining the farms of Messrs. G. and
S. Grimes, and within a few minutes'
walk of the ferry, South Brisbane.

Land Orders taken at market prices.

Transfer under the New Act.

TERMS—One-third cash, and the residue in 3,
6, 9, and 12 months—the two latter payments to
bear interest.

SATURDAY, NOVEMBER 15.

LAND. LAND.

THE FAIRFIELD ESTATE.

The remainder of this choice **LAND** will be
brought to the hammer on **SATURDAY,**
November 15.

TRENDLE & CAMERON will positively sell
the above valuable Property in Quarter,
Half, and Acre Allotments. Terms very liberal.
To newly-arrived Immigrants this Land could
be made available for Cultivation at once.

Sale at Noon.

SATURDAY NEXT, AT 12 O'CLOCK.

At the A.S.N. Company

5 bags Cotton

Sold on account of whom it

ARTHUR MARTIN will sell
the A.S.N. Co.'s Wharf,
NEXT, at 11 o'clock sharp,
5 bags Cotton Seed—to be
whom it may concern

No Reserve.

TUESDAY NEXT, AT 1

Thirty first-class Building
Having frontages to Leichhard
streets, Fortitude V

ARTHUR MARTIN will sell
the City Auction Mart,
and Edward streets, on **TUESD**
o'clock,

Thirty first-class Buildi
having frontages to
Brunswick streets, near
Fortitude Valley.

Plan on view at M

Terms liberal at 5

TUESDAY NEXT, AT 1

TO WINE AND SPIRIT
HOTELKEEPERS, STO
FAMILIES, AND OTHE

125 cases Geneva
100 casks Bottled Ale

ARTHUR MARTIN will sell
the City Auction Mart,
and Edward streets, on **TUESD**
o'clock,

125 cases Geneva, Key and
100 casks bottled ale as
factured expressly for
markets.
To be sold in bond, in lots to

Fairfield Town land
sales notice -
November 15, 1862



Fairfield wetlands,
1870s



Wurtemberg (sic) Farm 1880s



Fairfield
Baptist
Church, 1865



Fairfield
Baptist
Church, 1889



Ashby House – residence of George Grimes

The Wellauer
residence
“Edelweiss”
1912



20 Castle
Street
“Edelweiss”
today





“Irvinebank”
– residence
of Russell
Wilkins, 1911



“Irvinebank”
– 7 Redarc
Street, 2011

McKellar
Cadastral Map,
copyright 1887

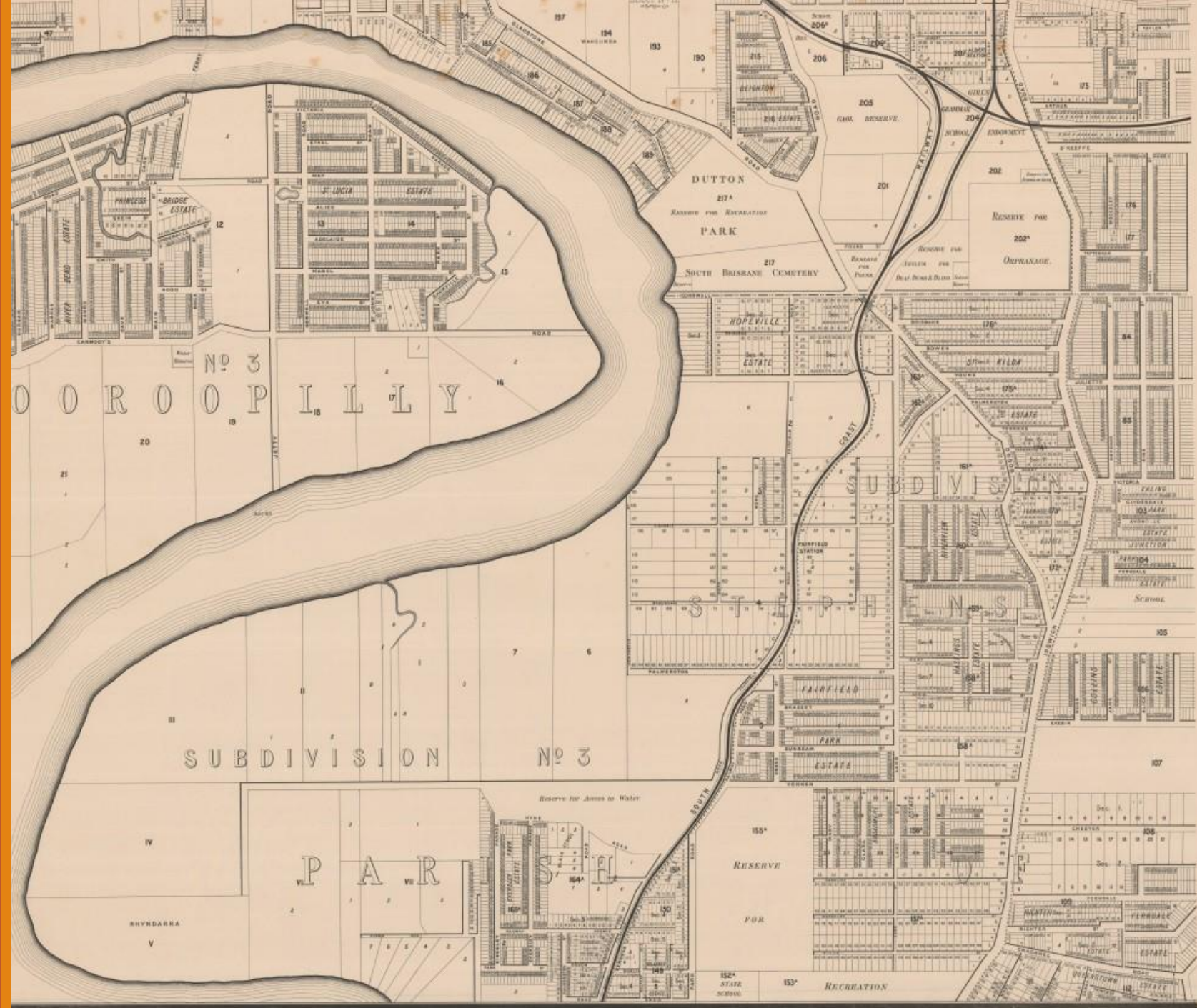



Looking
down
Princess
Street, 1936

Cattle yards Fairfield Station in Fairfield Rd Swamps Ashby St Axe-grinding grooves Venner Rd

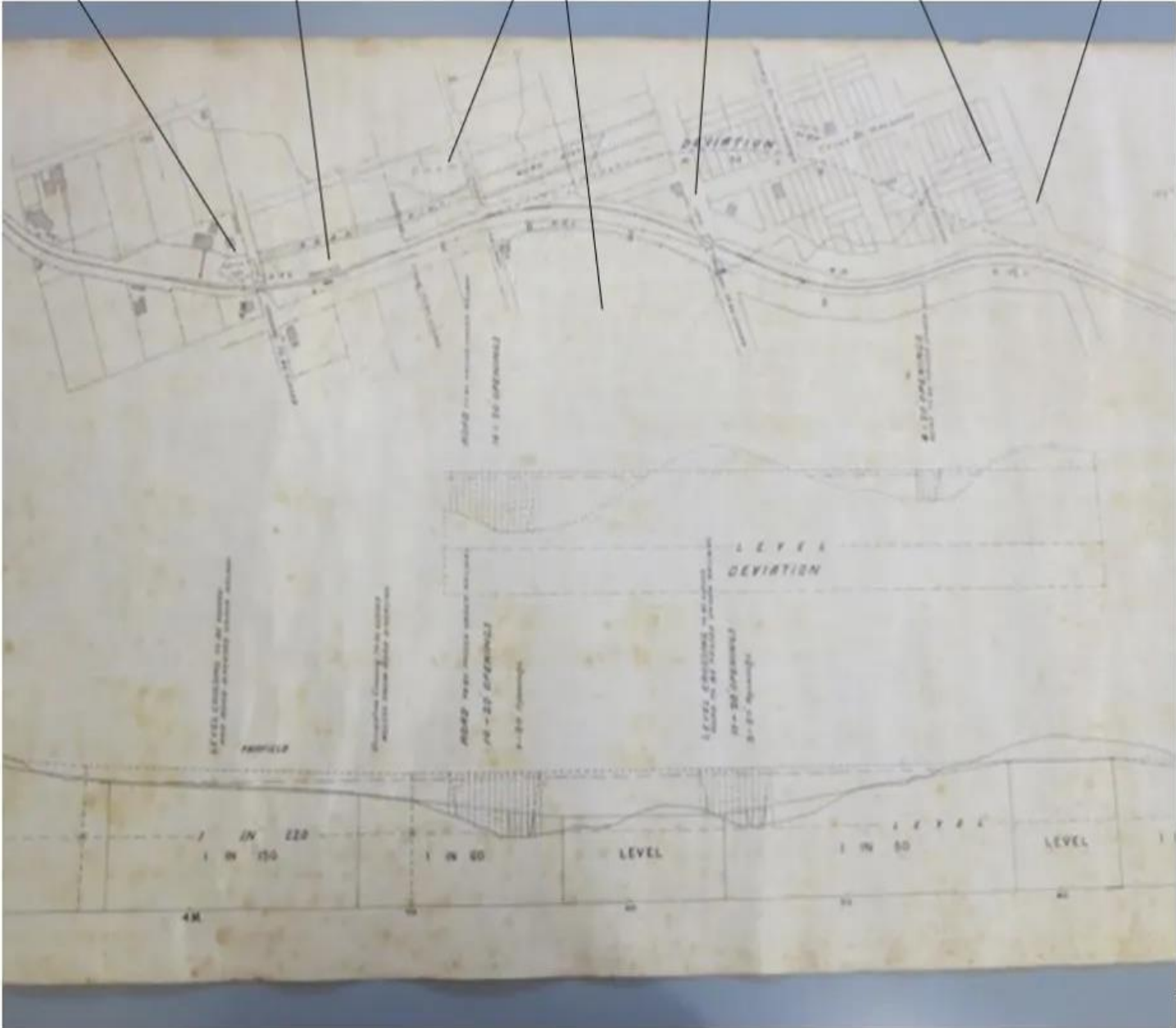

1891 railway line diagram



Fairfield Road between Princess and Fenton Streets, 1910

Bus turning into
Cornwall Street,
1948



McKellar
Cadastral Map,
copyright 1887

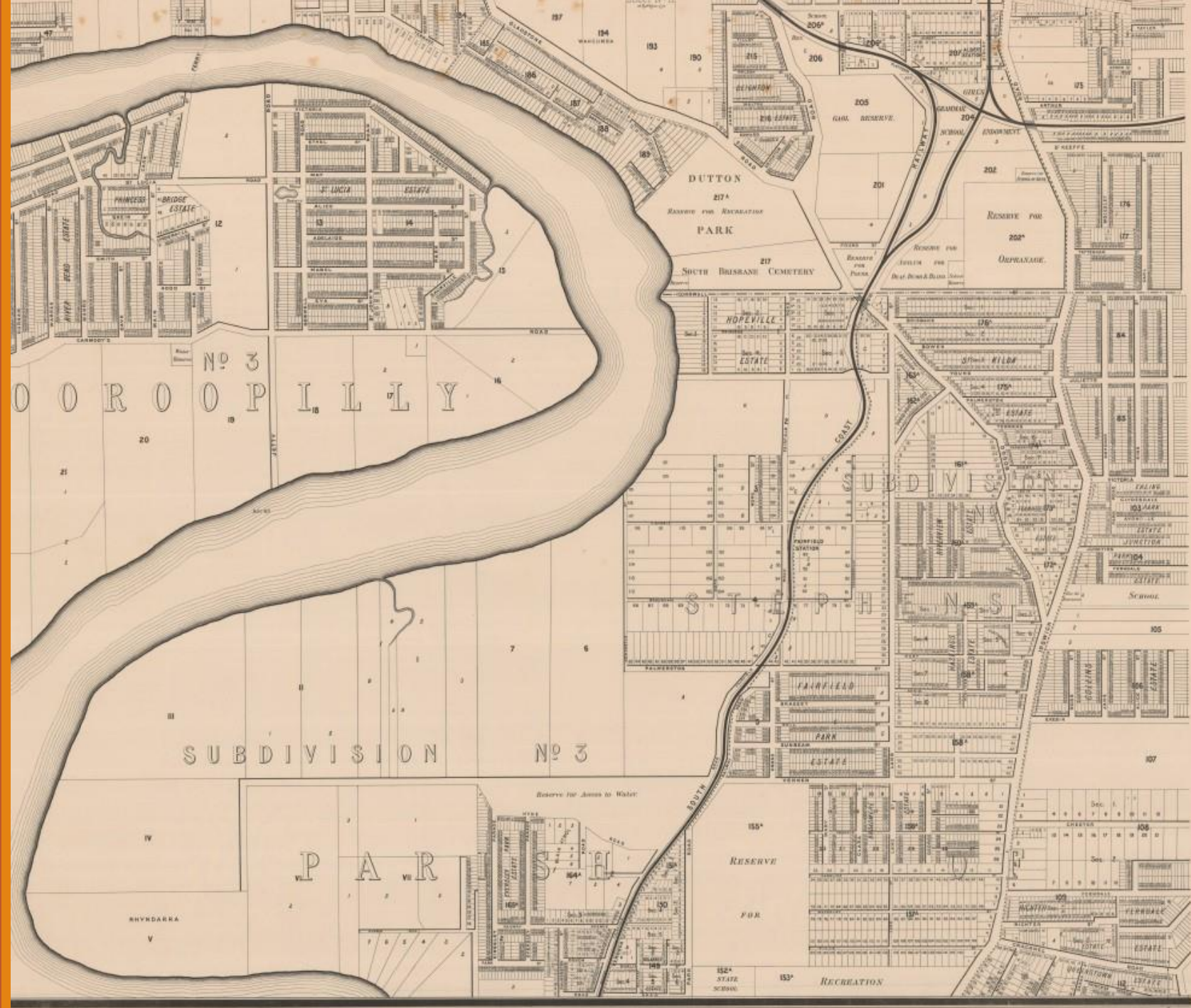

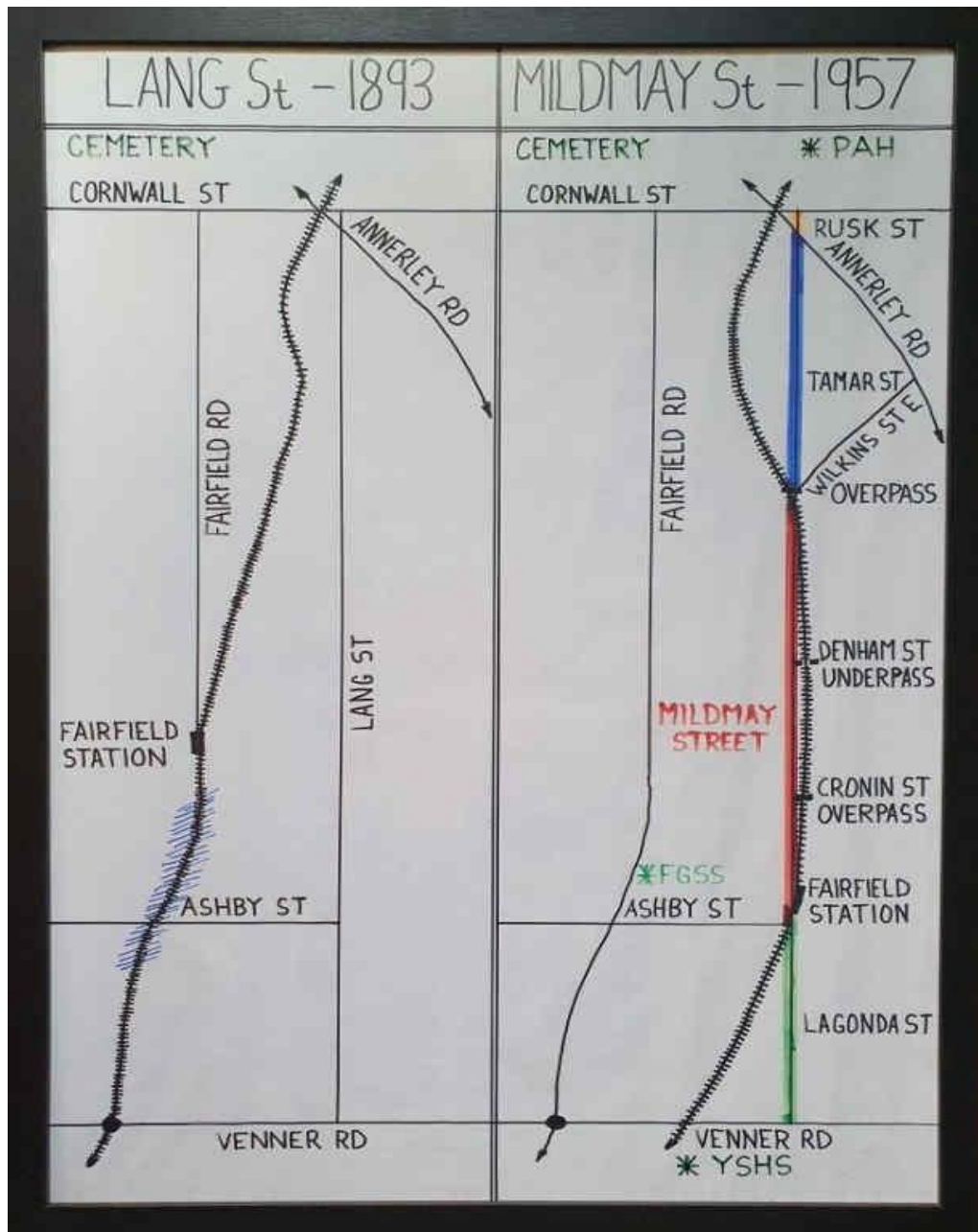

What happened to Lang Street?

RAILSIDE FAIRFIELD ESTATE

TERMS
 £1 DEPOSIT
 10/- per month
 Per Allotment
 5% Interest

A Splendid Train service.
 11 minutes to Town.
 Easy distance to Trams.

FOR SALE ON THE GROUND
SATURDAY 29TH AUGUST 1914.
 at 3 o'clock

28 CHOICE HILLSIDE SITES.
 High and Healthy
 Adjoining Railway Line.
 Within a stones throw from the Fairfield Railway Station.

Being Results 98 to 107,
 151 to 158 of Sub. C of Plan 5 and
 Results 1 to 10 of Sub. A & A of Result
 108 112, 122, 150, 159 to 164 of Sub. C of
 Plan 5 Parish of Yeerongilly.

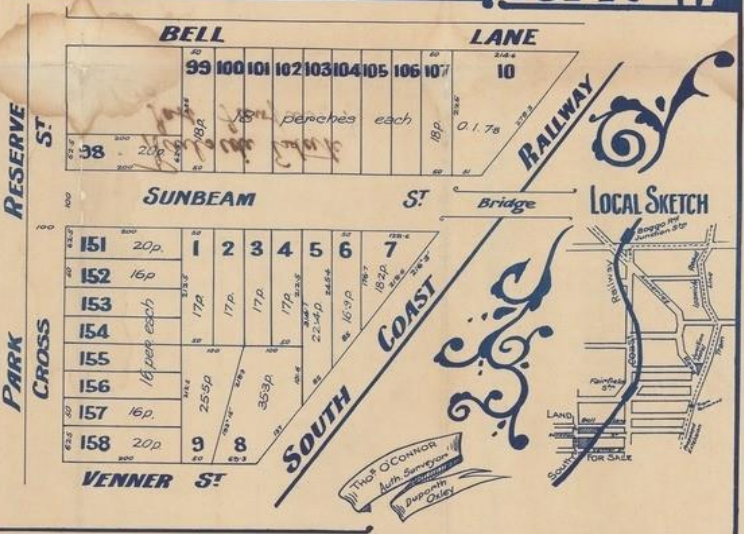

ISLES, LOVE & CO AUCTIONEERS

A. McKinnon, Draftsman, Telegraph Chambers, Brisbane.

Railside Estate, 1914



Fairfield Station, 1977

Typical Queensland houses surround Fairfield station on the line to Beenleigh. A pair of 2000 class rail motors departs for South Brisbane on 10/1/77.



Village Fair
held at
Dutton Park,
1909



View from Annerley c. 1900

South Fairfield and
Yeronga – Aerial
photo, 1936



Yeronga – 1936



R. Crump Family
Butcher, 1894



Time for a
Vincents and
a Coke?



George Tickle & Co Delivery Fleet, 1952



Tennyson Power Station



PRINCESS ALEXANDRA HOSPITAL

Princess Alexandra Hospital, 1970



Dutton Park Ferry Stop

Fairfield Road
Project Sign,
Robinson Park





Walking up Fairfield
Road, 1930

Looking down at
Fairfield from Dutton
Park, 1930





View from
Denham
Street, 1974

Fairfield Gardens,
January 2011 &
June 2011



Fairfield
population
since 1911

1911	570
1921	759
1926-1971	not available
1976	2404
1986	2134
1996	2184
2001	2140
2006	2579
2011	2554
2016	2980
2021	3106

A unique demographic?

2021 CENSUS	Fairfield	Qld
Indigenous %	1.8	4.6
Born Overseas %	30.4	28.6
Median age	32	38
Never married %	55.7	37.0
University degree %	49.5	21.9
Living in apartment %	28.6	12.5
Travel to work by PT %	12.3	4.1
Health	13.2% of workers	
Education	9.3% of workers	



Why is Fairfield so different?